

ABOUT THE SENSORY GARDEN

The Trellis entrance divides two separate gardens. To the right is a bed of conifers and to the left, two large beds consisting of a variety of shrubs, perennials and annuals which are identified in the illustrated map diagram. The plants in the conifer garden and the small bed of herbs are identified with labels within their garden space.

Plants in the Sensory Garden have been selected to stimulate the five senses, with new plantings added to provide interest throughout the year. Over half of the plants are native species, which attract and support a habitat for local wildlife.

We invite you to take a walk through the Garden and use the brochure's map and plant identification list to enhance your visit – and enjoy this aesthetic and sensory treat firsthand. In addition to admiring colorful blossoms and foliage as you stroll through the Garden, be sure to take time to touch, note various aromas, and listen carefully, to experience the Garden beyond the visual.

The majority of the plants identified in this brochure will remain from season to season, but gardens are dynamic—and change over time. So, do not be surprised to see some “newcomers” as you browse the Garden, or fail to find a favorite. Even plants have a mind of their own!

Interested in volunteering in our Garden?

Inquire inside the Walter Reed Community Center, or call 703-228-0949, and we'll add you to our list of volunteers. We welcome newcomers—tools and advice provided—expertise not required.

THE GARDEN'S HISTORY

Walter Reed's Garden began several years ago with separate plots that were tended by students and the Center's Bonsai Club participants. In the fall of 2013, Arlington County sought the assistance of Arlington's Master Gardeners to develop a plan to turn the separate plots into one large garden that would enhance the beauty of the Walter Reed Center.

Following the plan, the County moved boulders, dirt and mulch to create a garden, edged by a rock wall which curves between a pedestrian sidewalk and a lower gravel pathway. Donations were gathered, and volunteers contributed time and energy, sowing seeds, planting, weeding and watering—creating the Walter Reed Sensory Garden.

*To plant a garden
is to believe in tomorrow.*



WALTER REED COMMUNITY CENTER SENSORY GARDEN



2909 16th St. South, Arlington

The Sensory Garden has been developed by and is maintained by volunteers, through the leadership of the Walter Reed Senior Advisory Committee.

The Committee is grateful to our many volunteers for their support and assistance.

Walter Reed Sensory Garden

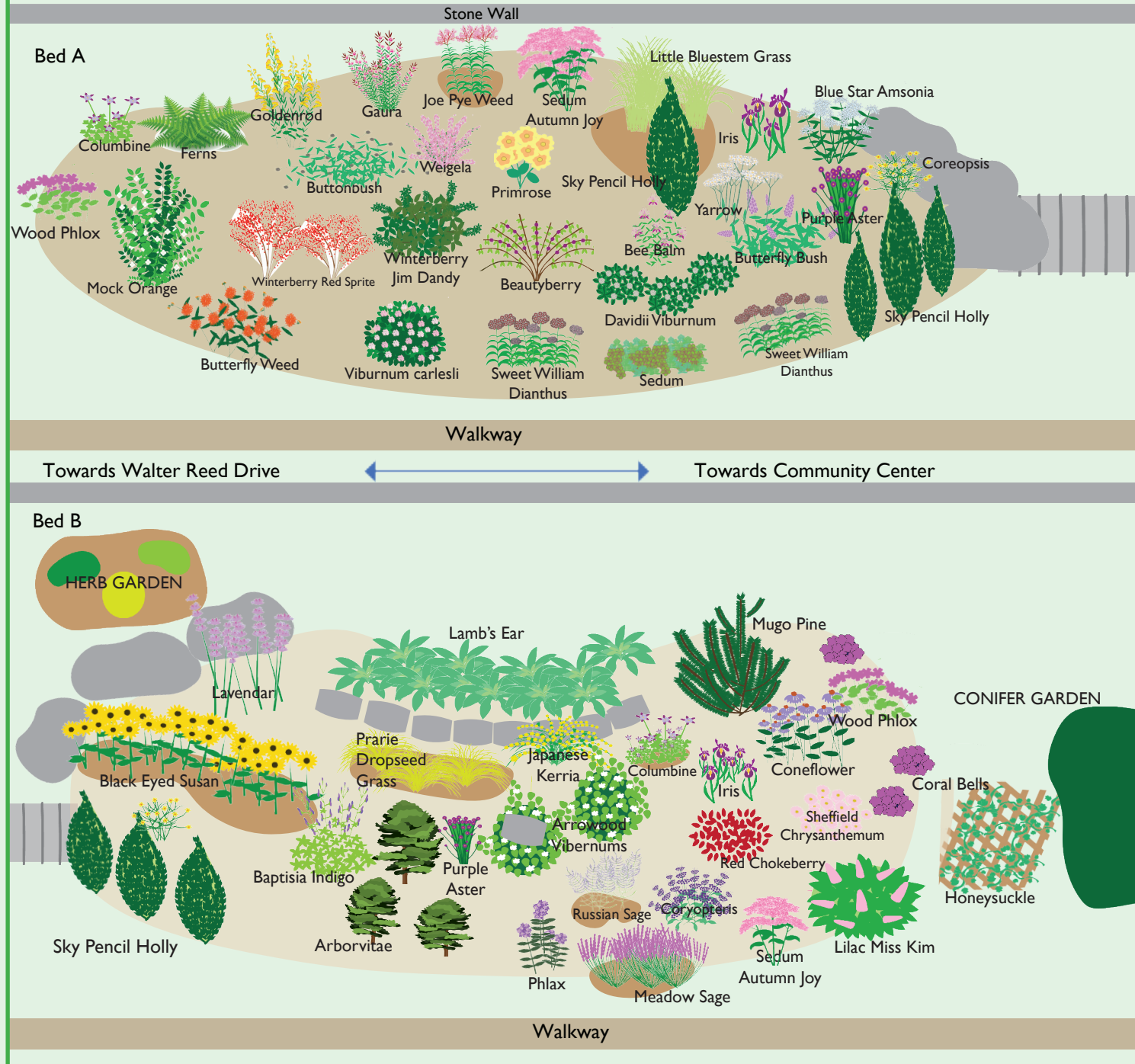

WALTER REED SENSORY GARDEN