

AREA 9 MAC - EMERGENCY DIVERSION ROUTES

A49 Trunk Road Northbound Closure B4371 Church Stretton to A5 Shrewsbury Bypass

Route Identification Number

EDR No: T070-A49-N-69021-TT66

T67

ROUTE CARD No.

This map is based upon Ordnance Survey material with the permission of Ordnance Survey on behalf of the Controller of Her Majesty's Stationary Office © Crown copyright. Unauthorised reproduction infringes Crown copyright and may lead to prosecution or civil proceedings. Highways Agency 100016928 2010

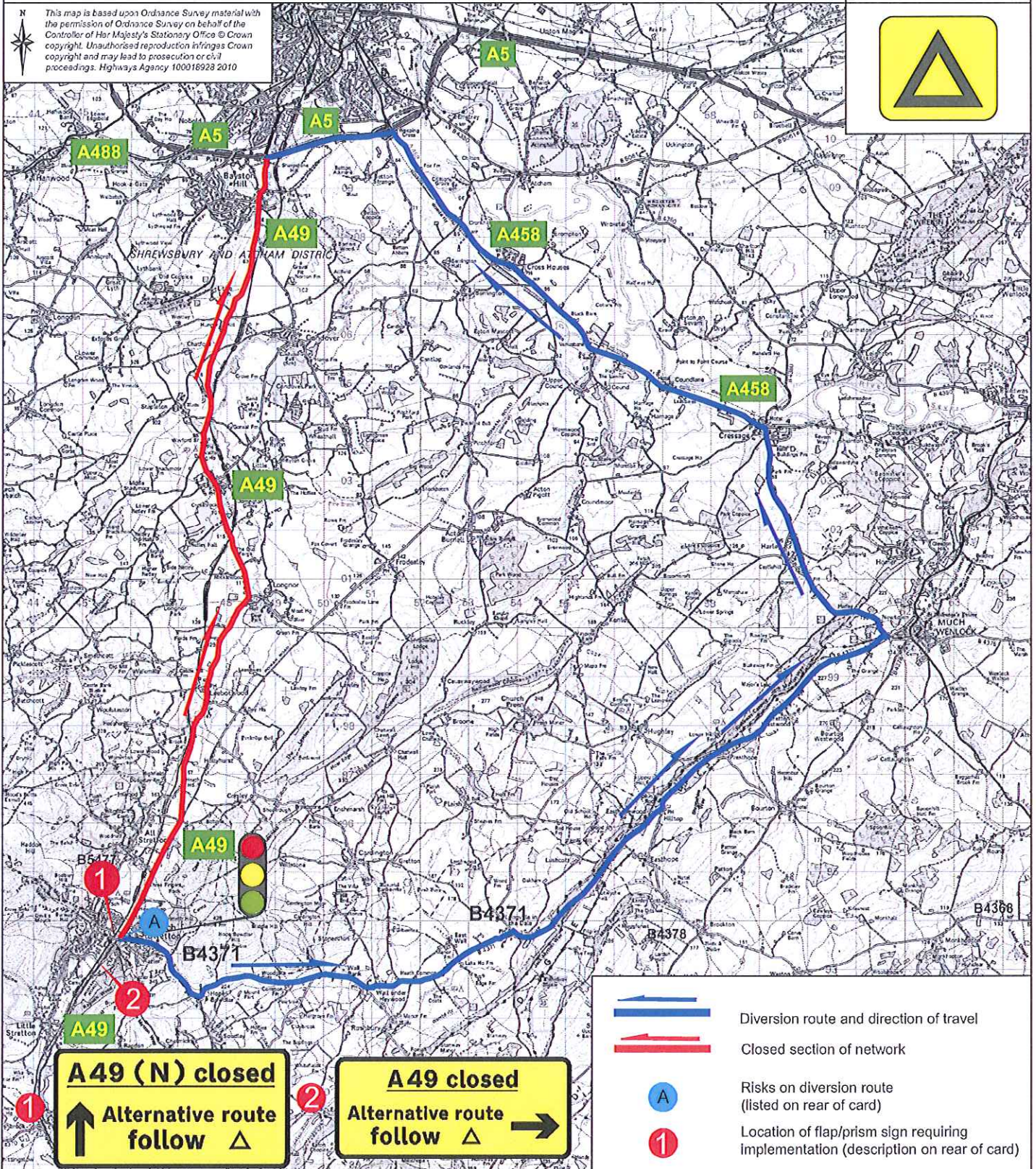

HIGHWAYS
AGENCY

Drawing Number: 9/206662/DR/69021/1	Drawn By: Date: DH APRIL 10	Scale: N.T.S.	Checked By: Date: RB 22/09/10	Approved By: Date: SA 22/09/10	Revision: FINAL Rev 2
--	----------------------------------	------------------	------------------------------------	-------------------------------------	--------------------------

AREA 9 MAC - EMERGENCY DIVERSION ROUTES

A49 Trunk Road Northbound Closure B4371 Church Stretton to A5 Shrewsbury Bypass

T67

ROUTE CARD No.

Route Identification Number

EDR No: T070-A49-N-69021-TT66

ROUTE DESCRIPTION

- At the junction of A49/B4371, Church Stretton, take the B4371 eastbound.
- Continue along B4371 to Much Wenlock.
- At the junction of B4371/A458 take the A458 northbound.
- Continue along A458 northbound to its junction with A5.
(Route length = 24.2 miles)



PHYSICAL IMPLEMENTATION

- 1 Set up Flap Sign located on A49, northbound approach to the A49 / B4371 junction.
 - 2 Set up Flap Sign located on B4371, eastbound approach to B4371 / A49 junction
- Initiate agreed Tactical (and Strategic) Variable Message Signing Plans.
 - Once Trunk Road is re-opened to traffic, close signs in the same order as opening them and close down VMS Plans

RISK MITIGATION

- A Hold all AILs, transporters, large cranes, selected AILs, etc on network.

CONTACTS

National Traffic Control Centre

West Midlands Regional Control Centre

Amey Network Control Centre

Worcestershire County Council

West Mercia Police

Refer to general contact list for contact numbers

Drawing Number:

9/206662/DR/69021/2

Drawn By: Date:

DH | APRIL 10

Scale:

N.T.S.

Checked By: Date:

RB | 22/09/10

Approved By: Date:

SA | 22/009/10

Revision:

FINAL Rev 2