

PLANNED AMENITIES

- ① Four (4) field complex with 300' outfield dimensions, dirt infield and warning track, synthetic turf outfield, LED sports lighting, scoreboards, chain link fencing, covered dugouts, bullpens, and covered bleachers.
- ② One (1) adaptive use field with safety surface. All associated amenities for this field to meet ADA accessibility standards.
- ③ Warm-up area
- ④ Inclusive covered playground area with picnic shade structures.
- ⑤ Restroom building
- ⑥ Ticket offices and entry gates
- ⑦ Fenced event area (15.5 acres) with synthetic turf fields and chat rock perimeter and access paths.

- ⑧ Event production building and main stage
- ⑨ Maintenance building and materials storage yard
- ⑩ Gated maintenance and event production access road
- ⑪ Gateway feature (monument, signage, art, etc.)
- ⑫ Sixteen (16) court pickleball complex with LED lighting, shade structures and benches.
- ⑬ Plaza with shade structures, seating, walking loops, and passive play lawn areas.
- ⑭ Future programmed field area

 Property Line - Approximately 270 total acres

EXISTING AMENITIES

- ① Desert Breeze community and aquatic center
- ② Four (4) field complex with 300' outfield dimensions, dirt infield and warning track, synthetic turf outfield, LED sports lighting, chain link fencing, covered dugouts, bullpens, covered bleachers, and restroom / concession building.
- ③ Skate area
- ④ Two (2) roller rinks
- ⑤ Two (2) basketball courts
- ⑥ Playground area with restroom, shade structures, and open play lawn area.
- ⑦ Three (3) run dog park (approx. 2 acres)
- ⑧ Five (5) soccer fields with lighting and adjacent open lawn area

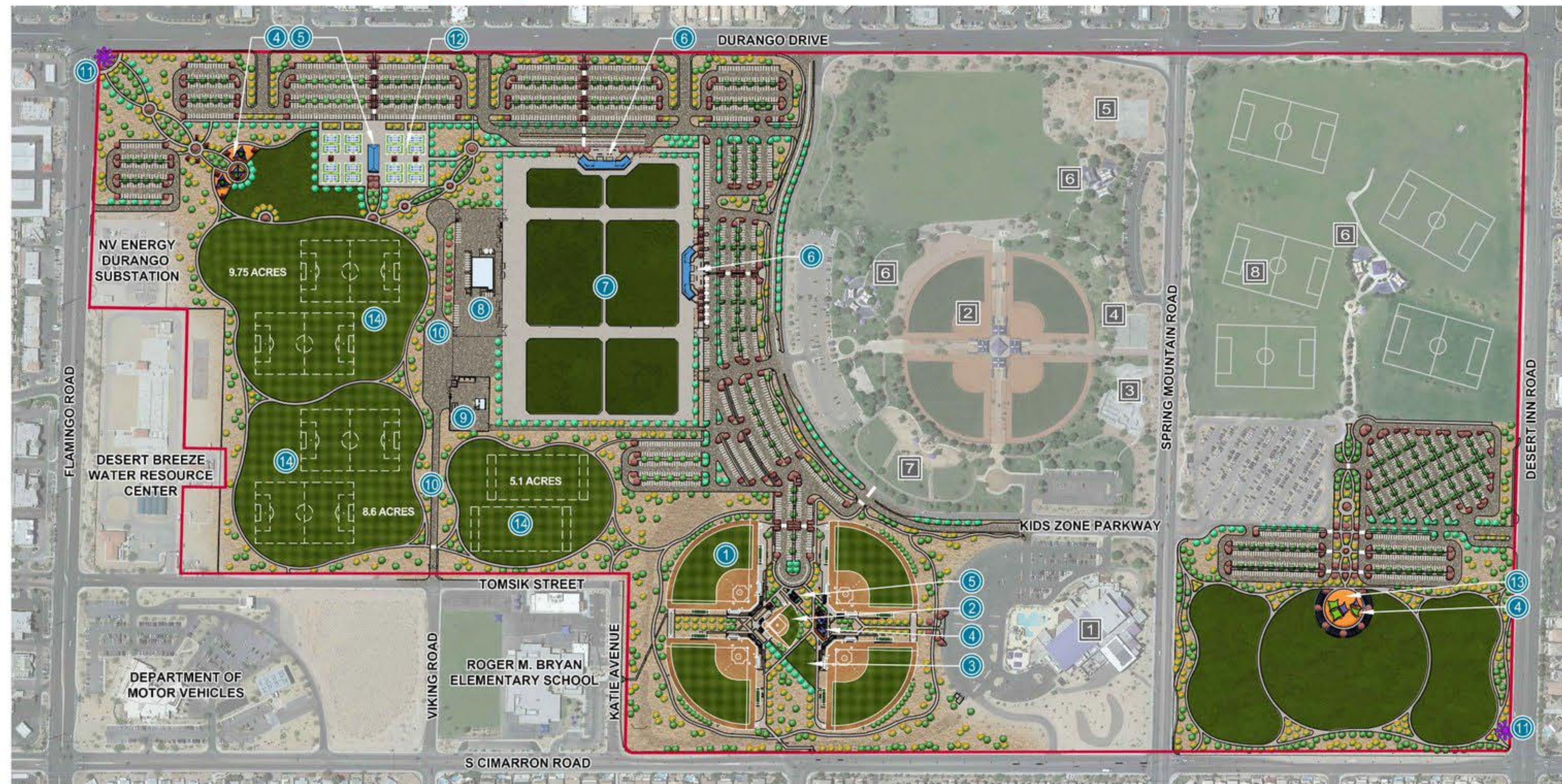

DESERT BREEZE REGIONAL PARK

MASTER PLAN
AUGUST 26, 2022

SCALE: N.T.S. NORTH 



702.597.3108 • 1700 w horizon ridge pkwy suite 203 • henderson, nv 89012
www.slalandarchitects.com