

# Hennepin Ave S Reconstruction Project

(W Lake St. to 26th St)

## Construction & Traffic Impact Update

June 8- 14, 2025



Construction work:



Partial Intersection Restriction

Sanitary Sewer



Conduit Work



Storm Sewer

Traffic impact:



Lane Closures/Work Zone



Travel Lanes



Roadway Closure



Roadway & Sidewalk work

Page 1



## WHAT'S HAPPENING

### Lake St to 26th St

- Hennepin Ave is open to traffic.
- Buses have returned to Hennepin
- There will be misc. work in the area during the spring months
- Planter rail installation will continue on Phase 1 around all planter boxes.
- Misc. punchlist work will continue



## WHAT TO EXPECT

### Lake St to 26th St

- Roadway and utility punchlist work and final landscaping will occur in the spring months. This will require periodic short term closures of the bus/parking lane during the day.
- Cross streets will at times be reduced to 1-lane.
- Parking lanes will be closed at certain locations on side streets.
- Business access will remain open during the construction.
- Pedestrian detours will be set up as needed. Greater impacts can be expected at intersections where work is occurring.



## STAY CONNECTED

### Visit the project website

Sign up for project updates on the project website.

[Minneapolismn.gov/government/projects/hennepin-ave-s/](https://minneapolismn.gov/government/projects/hennepin-ave-s/)



## CONTACT US

Adam Hayow, Project Engineer - Public Works

📞 612-673-2172 📧 adam.hayow@minneapolismn.gov

# Hennepin Ave S Reconstruction Project

( W 26th St. to Douglas Ave)

## Construction & Traffic Impact Update

June 8- 14, 2025

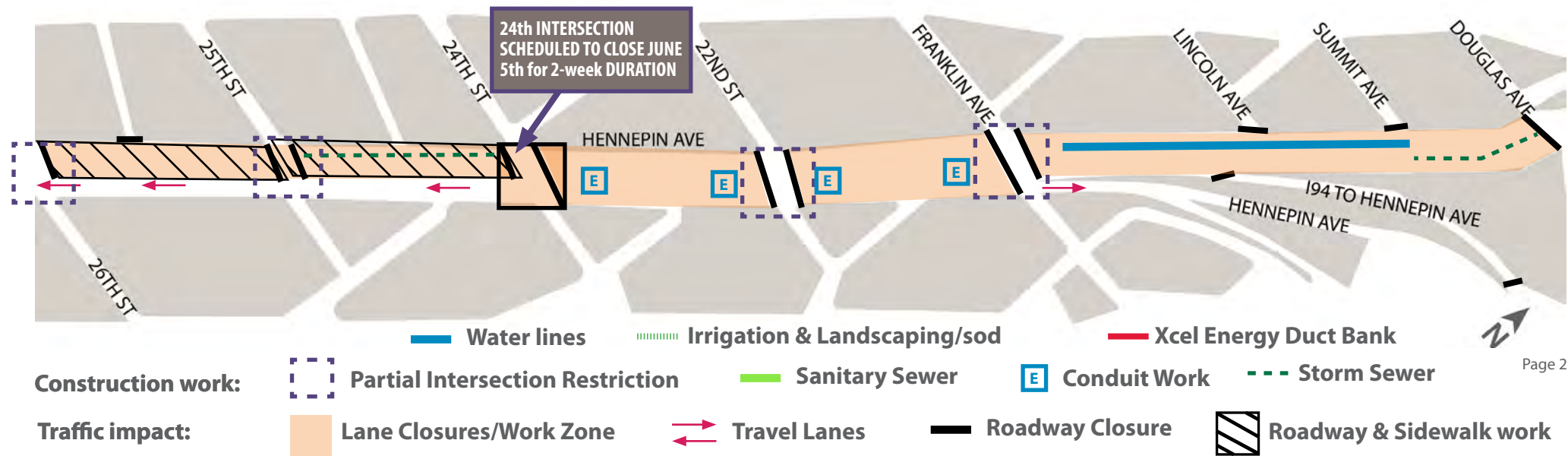

Page 2



### WHAT'S HAPPENING

#### 26th St to Douglas Ave

- Roadway construction has begun. This work includes removals, sawcutting, grading, storm sewer work and water service replacement
- Hennepin is closed from Douglas to 24th-Work is being done to replace hydrants, water services, storm sewer and sanitary sewer structure reconstructs.
- Roadway grading, placing gravel, and preparing for concrete curb pours will begin between 26th & 25th on the west side.



### WHAT TO EXPECT

#### 26th St to Douglas Ave

- Roadway & Utility work using heavy equipment will increase noise, vibration, and dust in work areas and sidewalks.
- Cross streets will at times be reduced to 1-lane or closed to traffic.
- Parking lanes will be closed at certain locations on side locations.
- Business access will remain open during the construction.
- Pedestrian detours will be set up as needed. Greater impacts can be expected at intersections where work is occurring.
- Traffic Delays in the area, closures, and detours.



### STAY CONNECTED

#### Visit the project website

Sign up for project updates on the project website.

[Minneapolismn.gov/government/projects/hennepin-ave-s/](https://minneapolismn.gov/government/projects/hennepin-ave-s/)



### CONTACT US

Adam Hayow, Project Engineer - Public Works

📞 612-673-2172 📧 adam.hayow@minneapolismn.gov

# Hennepin Ave S Reconstruction Project

(W Lake St. to Douglas Ave.)

## Block-by-Block Work Summary

June 8- 14, 2025



STREET BLOCK	PROJECT RELATED WORK	ANTICIPATED ROAD/PEDESTRIAN RESTRICTIONS				
		TEMPORARY PED RAMPS	PARKING RESTRICTIONS	TWO LANES OPEN (5-9 AM + 3-7 PM)	ONE LANE OPEN	NOTES
Lake St. Intersection						
Lake St. - Lagoon Ave	Punchlist					
Lagoon Ave Intersection						
Lagoon Ave -29th St.	Punchlist					
29th St. Intersection						
29th St. - 28th St.	Punchlist					
28th St. Intersection						
28th St. - 27th St.	Punchlist					
27th St. Intersection						
27th St - 26th St.	Punchlist					
26th St. Intersection						
26th St. -25th St.	Concrete Curb	X	X		X	Single Business access lane south bound
25th St. Intersection		X	X			
25th St - 24th St.	Concrete Curb	X	X		X	Single Business access lane south bound
24th St. Intersection	Removals, Hydrant work, concrete curbing	X	X			CLOSED
24th St. - 22nd St.	Electrical		X		X	Closed
22nd St. Intersection		X	X			
22nd St. - Franklin Ave.	Electrical		X			Closed
Franklin Ave. Intersection			X			
Franklin Ave -Lincoln Ave.	Hydrant replacements		X			Closed
Lincoln Ave. Intersection	Hydrant replacement and watermain offsets	X	X			Closed
Lincoln Ave. - Summit Ave.	Hydrant replacement and watermain offsets		X			Closed
Summit Ave. Intersection	Hydrant replacement and watermain offsets	X	X			Closed
Summit Ave. - Douglas Ave.	Storm Sewer		X			Closed

# Hennepin Ave S Reconstruction Project

(W Lake St. to Douglas Ave.)

Detour Routes  
June 8- 14, 2025

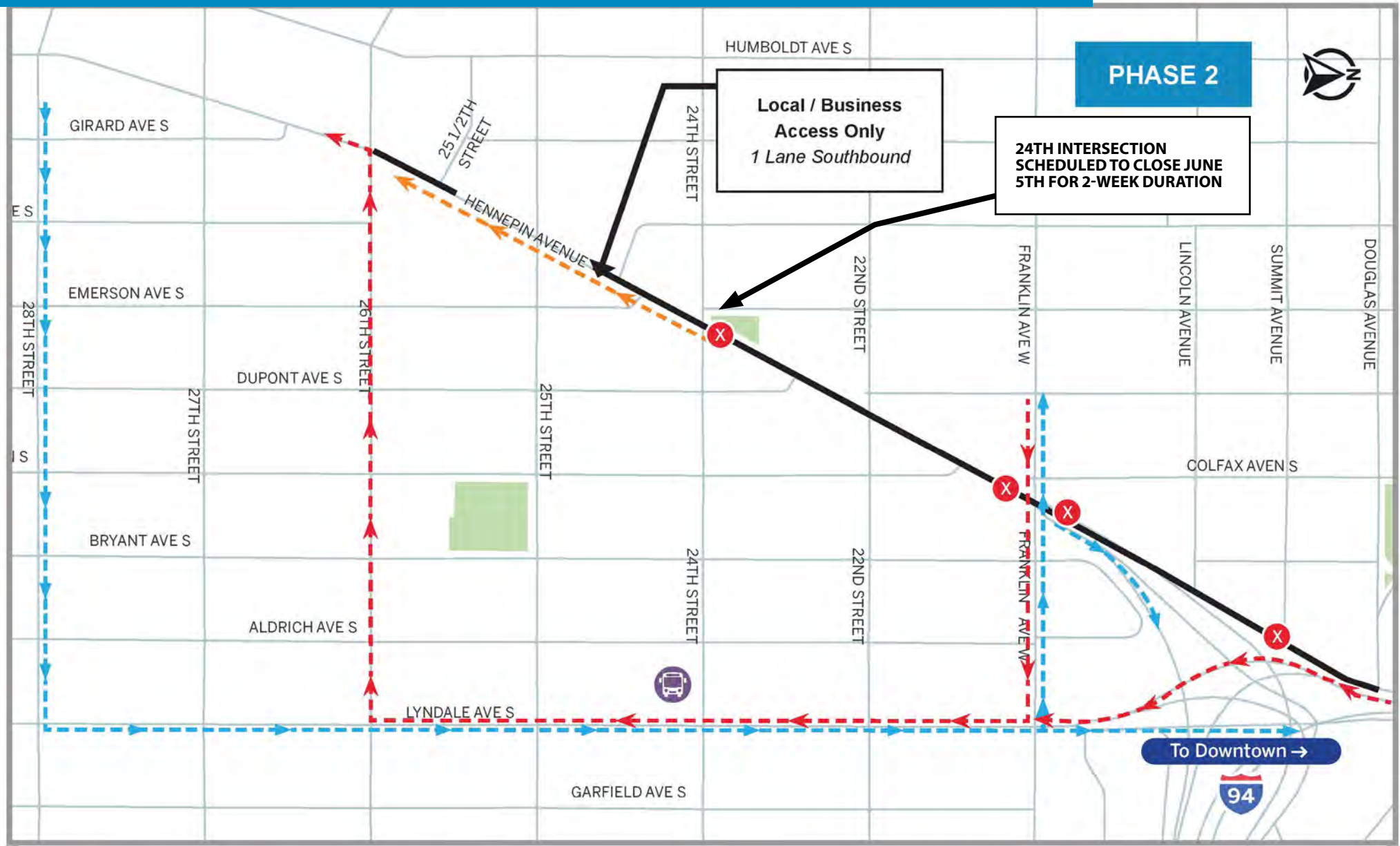

- Detour Route N
- Detour Route S
- Phase 2 Construction zone
- Business Access Route
- Road Closed
- Bus Detour



# Hennepin Ave S Reconstruction Project

(W Lake St. to Douglas Ave.)

Business Parking / Access

June 8- 14, 2025

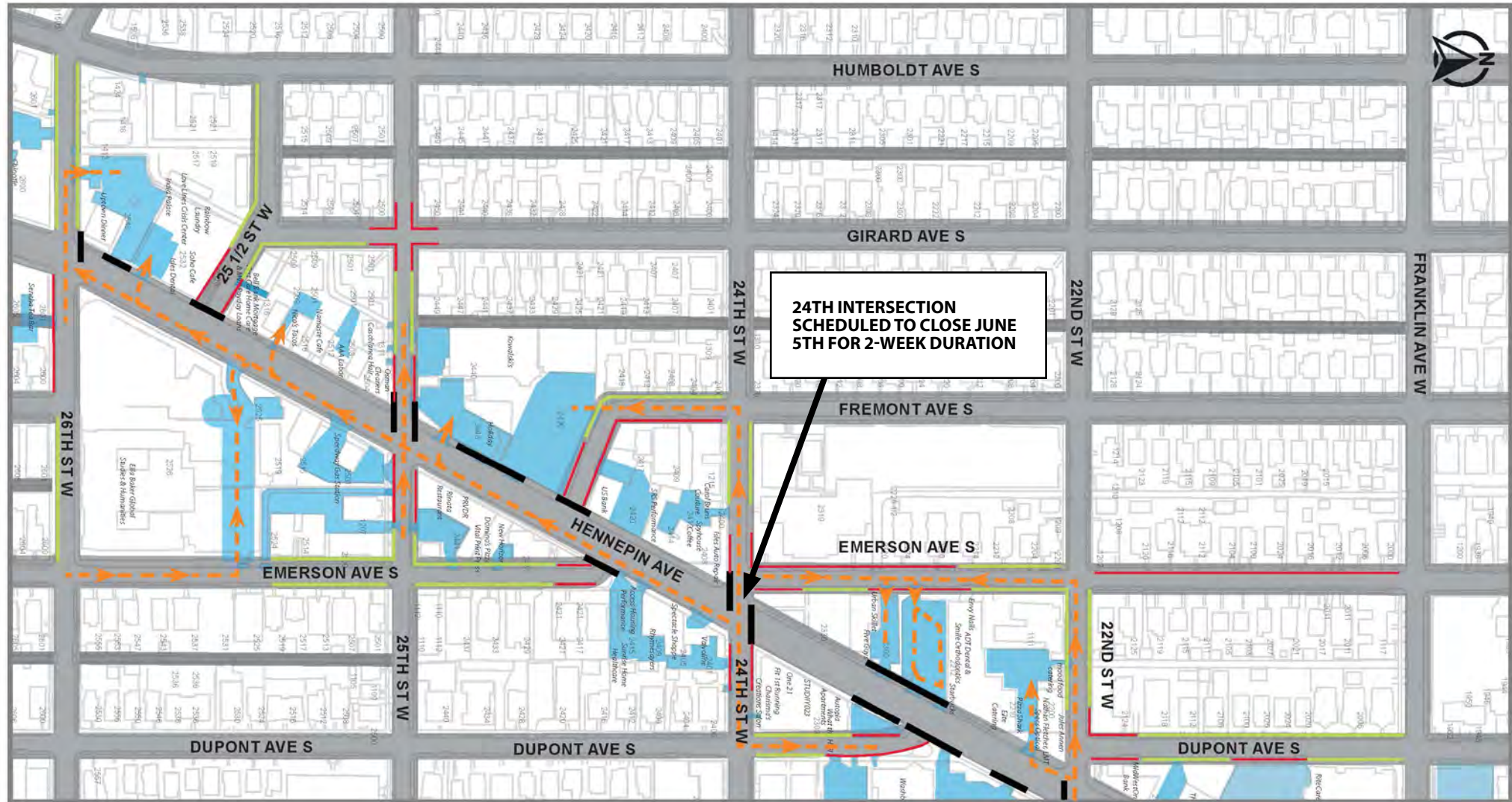

- Private/Business parking
- No Parking
- Onstreet Parking
- Road or Access Closed
- Business Access Route



# Hennepin Ave S Reconstruction Project

(W Lake St. to Douglas Ave.)

Business Parking / Access

June 8- 14, 2025

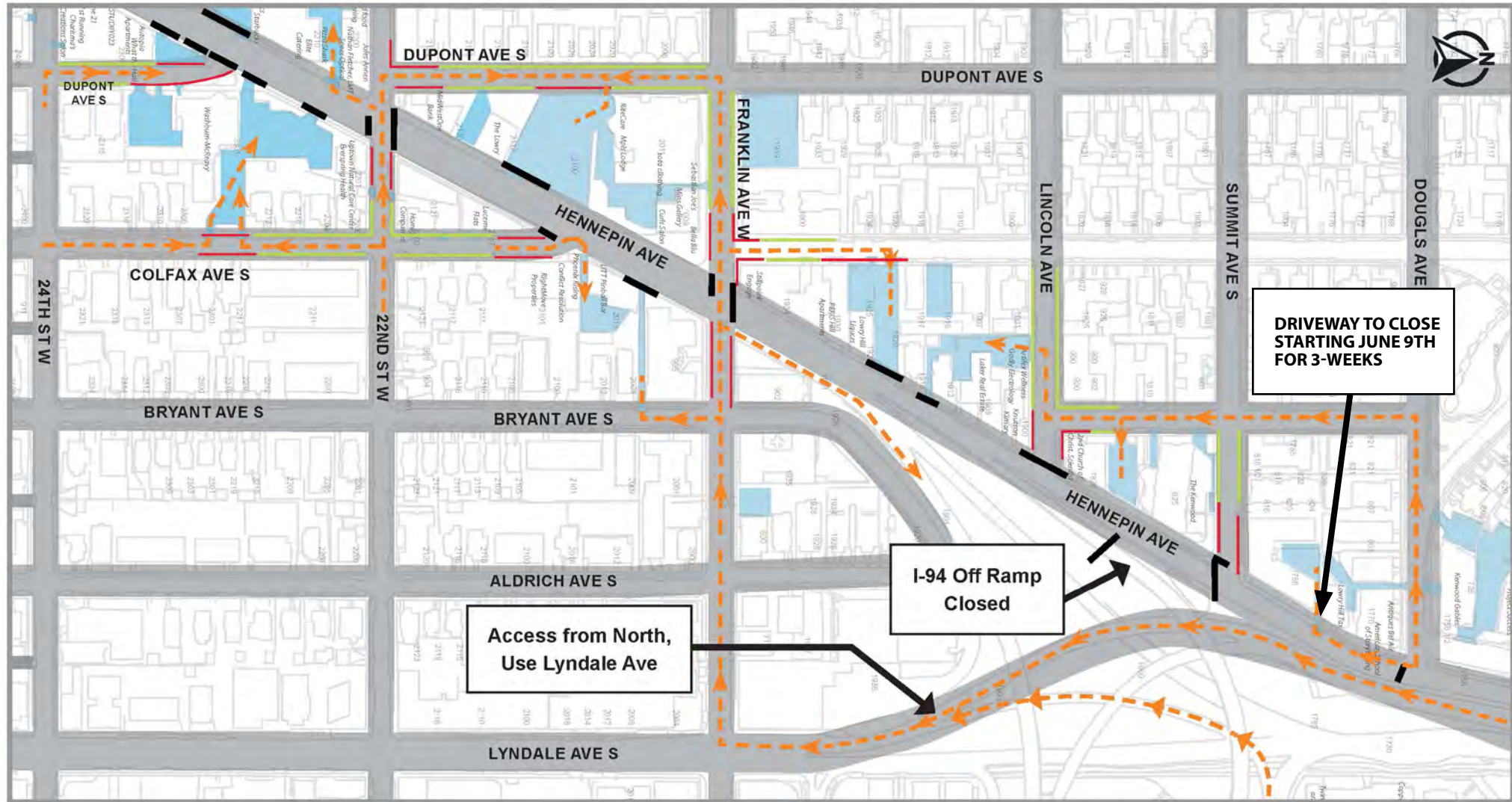

■ Private/Business parking   
 ■ No Parking   
 ■ Onstreet Parking   
 ■ Road or Access Closed   
 → Business Access Route



# Hennepin Ave S Reconstruction Project

(W Lake St. to Douglas Ave.)

In-Progress Images

June 8- 14, 2025



# Hennepin Ave S Reconstruction Project

(W Lake St. to Douglas Ave.)

In-Progress Images

June 8- 14, 2025





# Hennepin Ave S Reconstruction Project

(W Lake St. to Douglas Ave.)

In-Progress Images

June 8- 14, 2025





# Hennepin Ave S Reconstruction Project

(W Lake St. to Douglas Ave.)

In-Progress Images

June 8- 14, 2025





# Hennepin Ave S Reconstruction Project

(W Lake St. to Douglas Ave.)

In-Progress Images  
June 8- 14, 2025



# Hennepin Ave S Reconstruction Project

(W Lake St. to Douglas Ave.)

In-Progress Images

June 8- 14, 2025





# Hennepin Ave S Reconstruction Project

(W Lake St. to Douglas Ave.)

In-Progress Images

June 8- 14, 2025



# Hennepin Ave S Reconstruction Project

(W Lake St. to Douglas Ave.)

In-Progress Images

June 8- 14, 2025

