

Lexington Road and Cooper Street

Intersection Reconfiguration



Permitted: ✓

Westbound Lexington

Left Turn from Lexington to Cooper Street and to Lexington permitted. Use same turn lane.
Right Turn to and from 1139 Lexington Road.

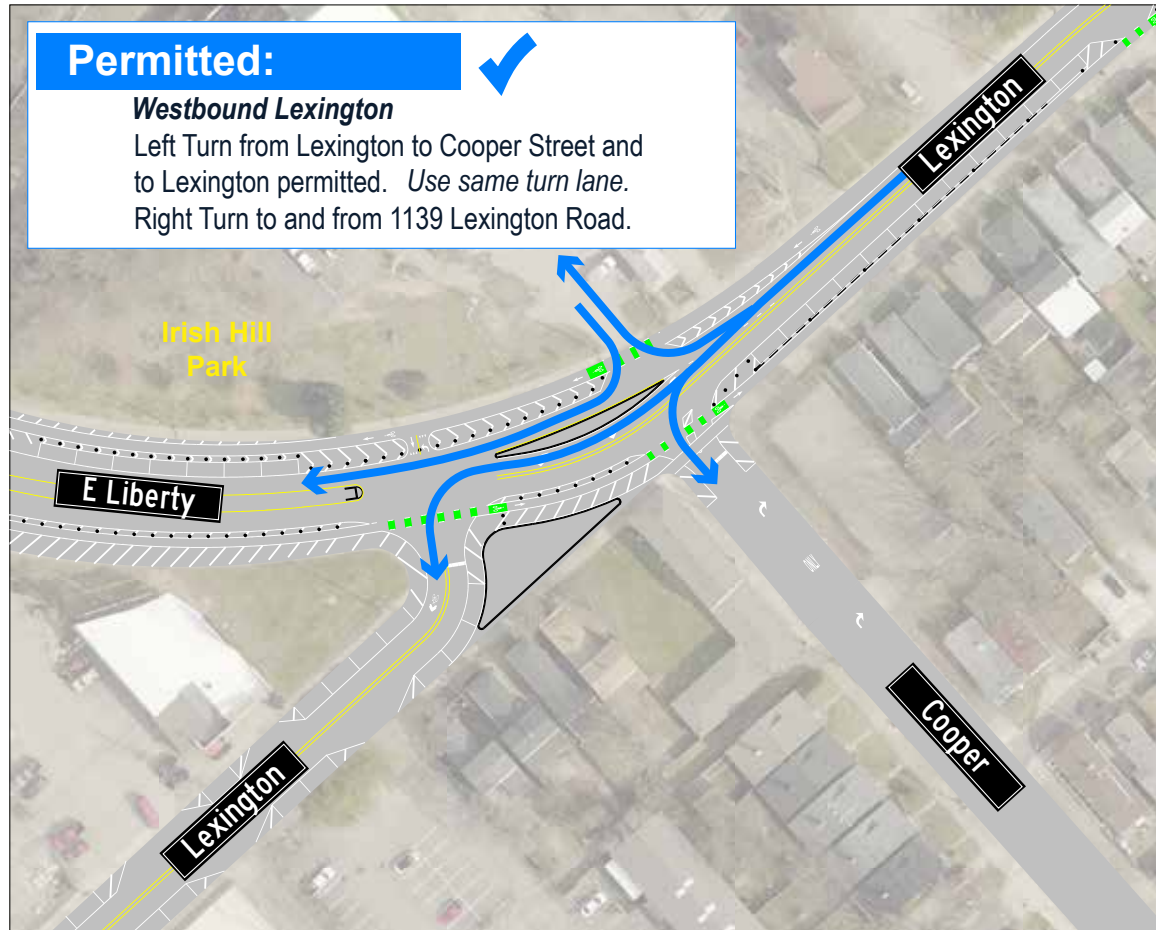

Permitted: ✓

Eastbound Liberty

Right-in and right-out at Cooper Street.
Right Turn to Lexington.

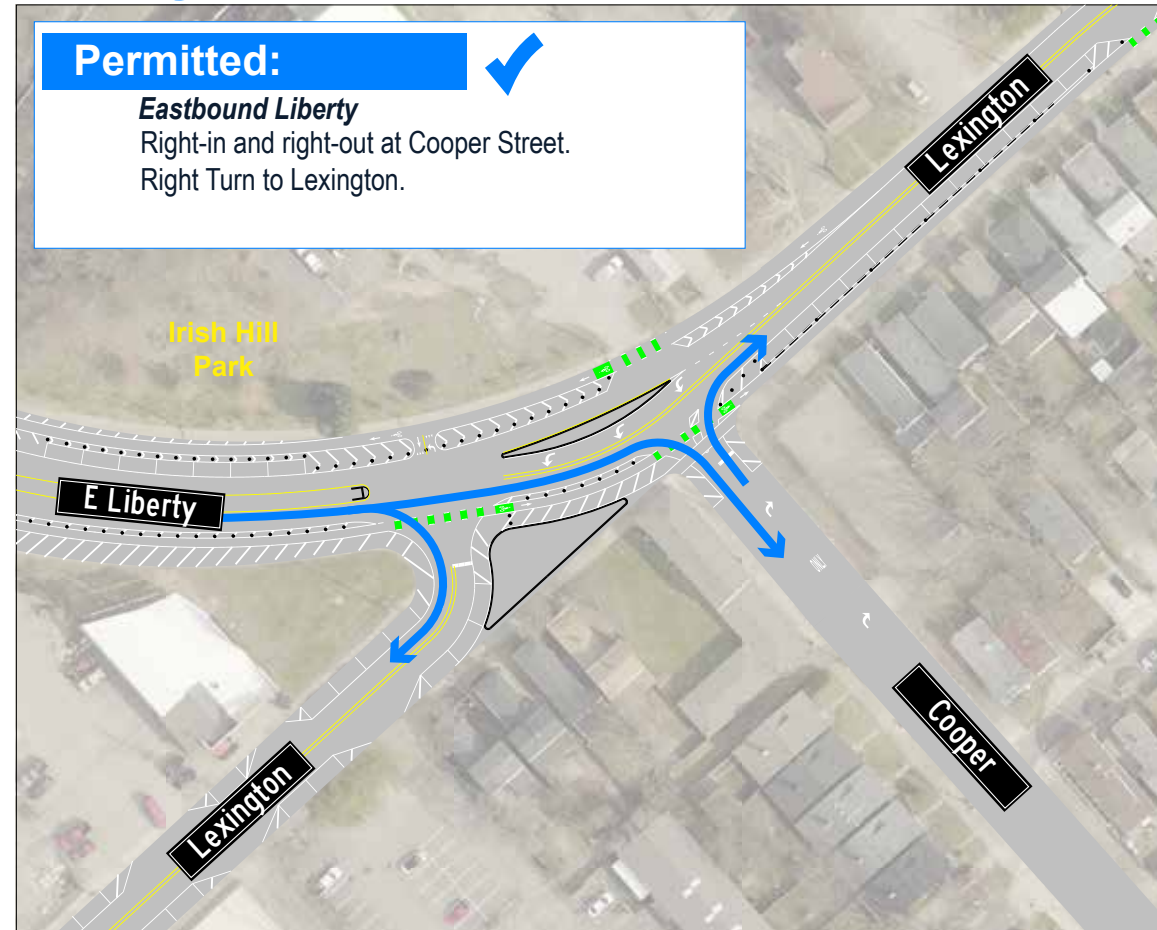

Permitted: ✓

Eastbound Lexington

Right and Left Turn from Lexington after Stop



Do not: ✗

Northbound Cooper

Turn Left from Cooper Street or 1139 Lexington Road
See Alternative Routing.

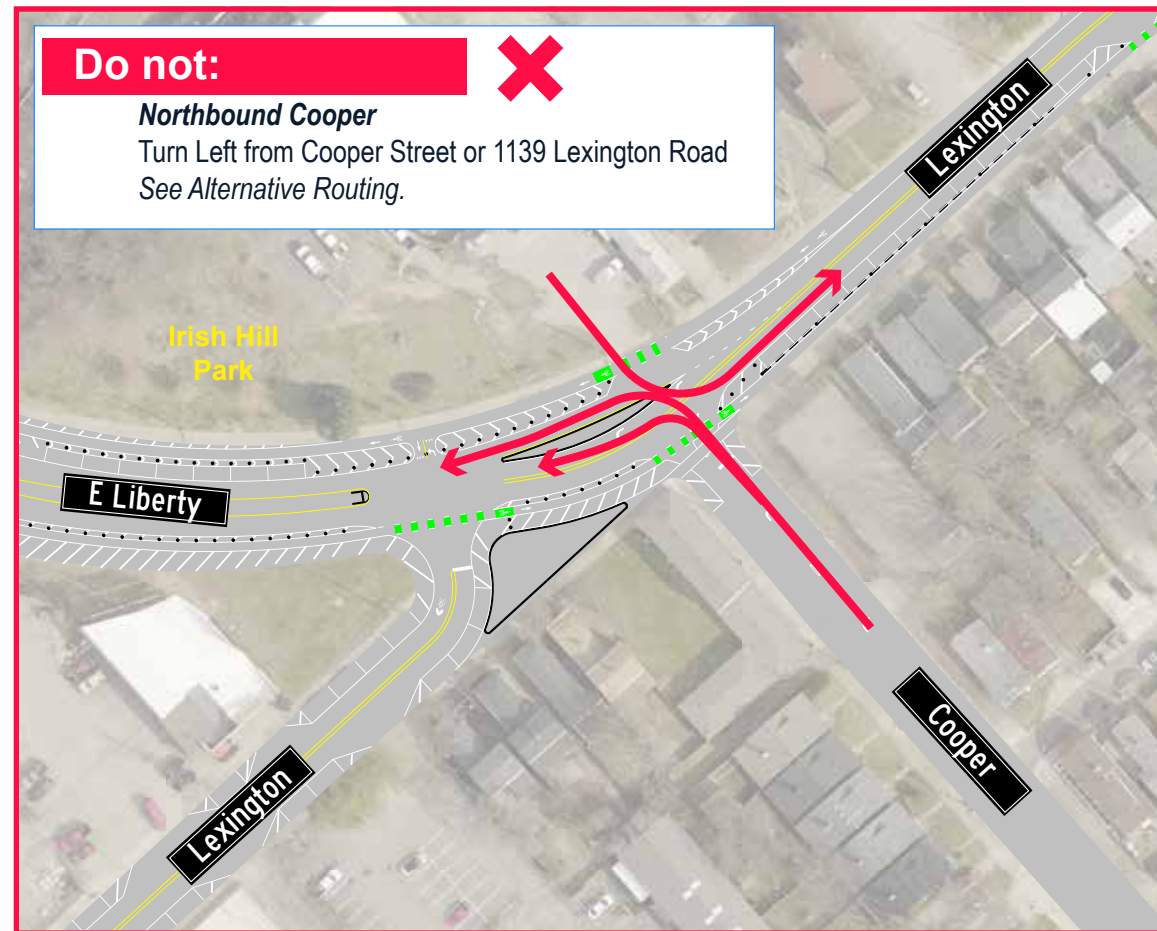

Project Purpose:

The project has the primary goal of improving safety. Reducing from 4-lanes to 2-lanes is estimated to reduce crashes by approximately 25%. Additionally, a median was added between Cooper and Lexington to align eastbound Lexington drivers in a better position to see traffic to their left approaching on Liberty, rather than having to look far over their shoulder. With the short distance between the realigned Lexington and Cooper intersections, left turns from Cooper are restricted to reduce the risk of crashes with westbound traffic.

Alternative:

Left turns from Cooper onto Lexington Road can now be routed onto Baxter Avenue via Hull St. if headed north, and via Payne Street if headed south

