

EROSION PREVENTION AND SEDIMENT CONTROL NOTE:

EROSION PREVENTION AND SEDIMENT CONTROL MEASURES SHALL BE IMPLEMENTED PRIOR TO ANY LAND-DISTURBING ACTIVITY ON THE CONSTRUCTION SITE. ANY MODIFICATIONS TO THE PLAN MUST BE APPROVED BY PARKS AND RECREATION PROJECT MANAGER. THE BMP'S SHALL BE INSTALLED PER THE PLAN AND MSD STANDARDS.

ACTIONS MUST BE TAKEN TO MINIMIZE THE TRACKING OF MUD AND SOIL FROM CONSTRUCTION AREAS ONTO PUBLIC ROADWAYS. SOIL TRACKED ONTO THE ROADWAY SHALL BE REMOVED DAILY.

SOIL STOCKPILES SHALL BE LOCATED AWAY FROM STREAMS, PONDS, SWALES, AND CATCH BASINS. STOCKPILES SHALL BE SEEDED, MULCHED, AND ADEQUATELY CONTAINED THROUGH THE USE OF SILT FENCE.

WHERE CONSTRUCTION OR LAND DISTURBANCE ACTIVITY WILL OR HAS TEMPORARILY CEASED ON ANY PORTION OF A SITE, TEMPORARY SITE STABILIZATION MEASURES SHALL BE REQUIRED AS SOON AS PRACTICABLE, BUT NO LATER THAN 14 CALENDAR DAYS AFTER THE ACTIVITY HAS CEASED.

SEDIMENT-LADEN GROUNDWATER ENCOUNTERED DURING TRENCHING, BORING OR OTHER EXCAVATION ACTIVITIES SHALL BE PUMPED TO A SEDIMENT TRAPPING DEVICE PRIOR TO BEING DISCHARGED INTO A STREAM, POND, SWALE OR CATCH-BASIN.

SEED ALL DISTURBED AREAS WITH A TURF TYPE FESCUE MIX AT THE RATE OF 8LBS. PER 1000 SQUARE FEET. MULCH LIGHTLY OVER THE SEEDED AREAS WITH STRAW.

CONSTRUCTION PHASING

1. INSTALL TEMPORARY CONSTRUCTION ENTRANCE AND ALL PERIMETER SILT FENCE AND ANY TREE PROTECTION FENCING PRIOR TO CONSTRUCTION ACTIVITY.
2. BEGIN DEMOLITION AND OFF SITE REMOVAL OF EXISTING CONCRETE PAD AND WALKWAY.
3. CONFIRM HORIZONTAL AND VERTICAL ALIGNMENT WITH PARKS PROJECT MANAGER PRIOR TO EXCAVATION.
4. COMMENCE EARTHWORK ACTIVITIES.
 - 4.1. REMOVE EXISTING TOPSOIL AND STOCKPILE.
 - 4.2. ROUGH GRADE SUB-GRADE OF ASPHALT PATH ACCORDING TO PLAN.
5. PLACE EXCESS SOIL IN CAVITY REMAINING FROM REMOVAL OF CONCRETE PAD.
6. PROOF ROLE SUBGRADE AND UNDERCUT FAILURE AREAS.
7. INSTALL 8" DGA BASE, THEN 2" BASE ASPHALT AND UPON APPROVAL FROM PROJECT MANAGER INSTALL 2" SURFACE ASPHALT.
8. SEED, STRAW, AND CRIMP ALL DISTURBED AREAS AS DIRECTED.



Know what's below.
Call before you dig.

GENERAL NOTES

1. CONTRACTOR IS HEREBY NOTIFIED THAT THERE ARE EXISTING UTILITIES WITHIN THE PROJECT AREA. CONTRACTOR SHALL BE HELD LIABLE FOR ANY AND ALL DAMAGE TO EXISTING UTILITIES, WHETHER SHOWN ON THIS PLAN OR NOT, AT NO COST TO METRO PARKS.
2. PRIOR TO CONSTRUCTION, CONTRACTOR SHALL BE RESPONSIBLE FOR HAVING ALL UTILITIES MARKED BY B.U.D.. IF B.U.D. WILL NOT PERFORM UTILITY LOCATES WITHIN THE PARK, CONTRACTOR SHALL RETAIN THE SERVICES OF A PRIVATE UTILITY LOCATING COMPANY AS PART OF THE CONTRACT.

B.U.D. NOTE

ALL UTILITIES ON THESE PLANS ARE APPROXIMATE. INDIVIDUAL SERVICE LINES ARE NOT SHOWN. THE CONTRACTOR OR SUB-CONTRACTOR SHALL NOTIFY THE UTILITY PROTECTION CENTER "BUD" FORTY-EIGHT HOURS IN ADVANCE OF ANY CONSTRUCTION ON THIS PROJECT. THIS SERVICE WAS ESTABLISHED TO PROVIDE ACCURATE LOCATIONS OF EXISTING BELOW GROUND UTILITIES (i.e. CABLES, ELECTRIC WIRES, GAS AND WATER LINES). THE CONTRACTOR SHALL BE RESPONSIBLE FOR BECOMING FAMILIAR WITH ALL UTILITY REQUIREMENTS SET FORTH ON THE PLANS AND TECHNICAL SPECIFICATIONS.

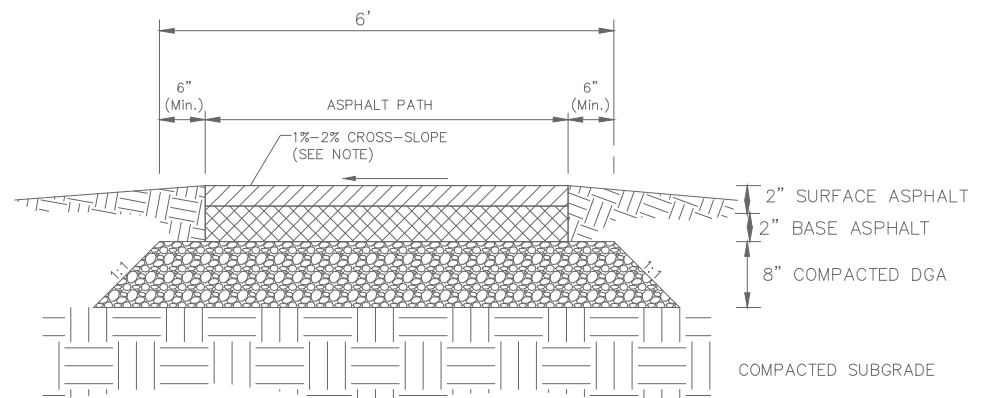
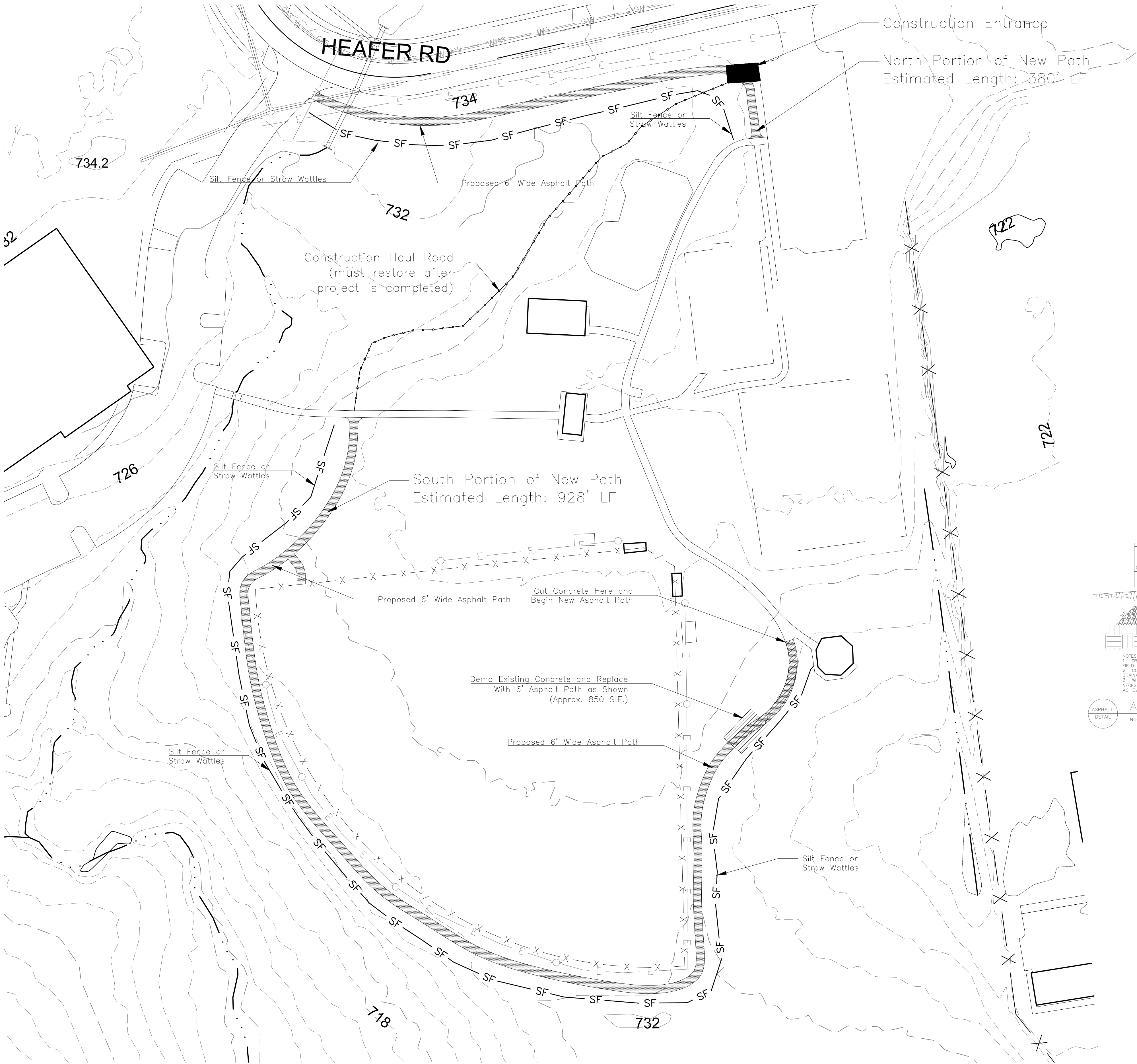

NOTES:
1. CROSS-SLOPE IS INTENDED TO BE 1%-2%, HOWEVER MAY BE FIELD ADJUSTED AS DIRECTED BY METRO PARKS PROJECT MANAGER.
2. CONTRACTOR SHALL GRADE ASPHALT PATH TO HAVE POSITIVE DRAINAGE.
3. WHEN PATH LOCATION IS LOCATED IN THE FIELD, IT MAY BE NECESSARY TO PROVIDE AN "INVERTED CROWN" IN ORDER TO ACHIEVE POSITIVE DRAINAGE.

ASPHALT PAVING DETAIL
NOT TO SCALE

- LEGEND
- EXISTING TREE
 - EXISTING SIGN
 - EXISTING CONTOUR (MINOR)
 - EXISTING CONTOUR (MAJOR)
 - EXISTING LIGHT POLE
 - PROPOSED LIGHT POLE
 - EXISTING WATER LINE
 - EXISTING FIRE HYDRANT

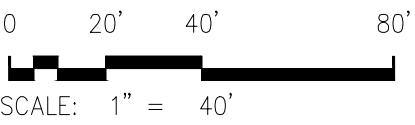

Note: All soil generated during construction will be lost on site where possible. Any excess soil will be trucked offsite to nearby parks facility.

Note: All new asphalt path edges are to be back dressed with soil and then seeded and covered with "Futerra Erosion Control Matting".



SCALE: 1" = 40'
DATE: 03-08-2023
DESIGNED BY: jtc
DRAWN BY: ssh
CHECKED BY: ..
LOG NO. 23xxx

REVISIONS: