



# Foothill Gold Line

-Glendora to Pomona-

**KIEWIT-PARSONS, A JV**

## NOTICE: Nighttime Lane/Directional Closures FOOTHILL BLVD & GRAND AVE INTERSECTION (CITY OF GLENDORA) APRIL 17 & 18, 2023, 8:00 PM - 6:00 AM

### CONSTRUCTION ACTIVITY

As a part of the 9.1-mile Foothill Gold Line light rail project, KPJV crews will be working overnight on Monday, April 17th, and Tuesday, April 18th, to complete a concrete pour on the new light rail bridge at the intersection of Foothill Blvd. & Grand Ave. in the city of Glendora. Lane and full directional closures will begin at 8:00 PM and operations will continue thru approximately 6:00 AM both days. Lane closures will occur as shown in the map below and heavy operations occurring from approximately 9:00 PM - 3:00 AM.

### WHEN

Monday, April 17th & Tuesday, April 18th starting at 8:00 PM - 6:00 AM with lane closures between **8:00 PM - 3:00 AM, lasting approximately 6 hours only.**

### TRAFFIC ADVISORIES

- Full closure of southbound Grand Ave., from Bennet Ave north of Foothill Blvd. to Carroll Ave south of Foothill Blvd., with the exception of southbound to westbound right turns will remain open. (see map below)
- Full closure of eastbound lanes on Foothill Blvd. east of Goodwill's driveway to Grand Ave. (see map below)
- Access to businesses including Goodwill and residential areas, surrounding lane closures, will be maintained at all times.

### PLAN YOUR ROUTE AND BE PREPARED

- A detour route (see map below) will be in place when the directional full closure is set and signage will be posted to direct motorists, trucks and pedestrians. Please follow detour signs.
  - ✓ Route 66 and Bennett Ave. (eastbound and westbound) will remain open and serve as detour routes, see details below.
  - ✓ Barranca Ave., Glendora Ave., and Vermont Ave. (northbound and southbound) will remain open and serve as detour routes.

### NOTE TO RESIDENTS / BUSINESS OWNERS

- Noise from construction equipment will be produced near the active work zones.
- Bus stops may be temporarily relocated, for more information:
  - ✓ Foothill Transit Bus: (800) RIDE-INFO/ (800) 743-3463 or [foothilltransit.org](http://foothilltransit.org)

### STAY SAFE

Please obey all posted construction signs and do not enter the construction work zone.

**Para información en español por favor llame o envíe un mensaje de texto a (626) 513-5788.**

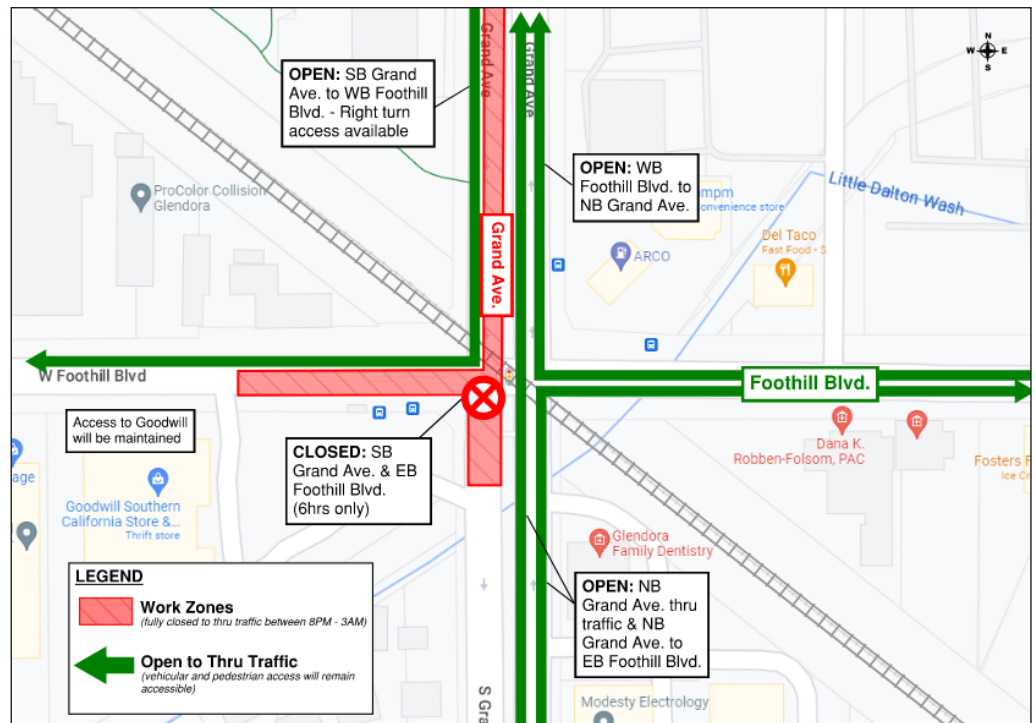

### QUESTIONS?

**Project Construction Questions Hotline:** (626) 513-5788 **Email:** [CommunityRelations@Kiewit-Parsons.com](mailto:CommunityRelations@Kiewit-Parsons.com)

**General Project Questions:** (626) 471-9050 **Email:** [PublicAffairs@Foothillgoldline.org](mailto:PublicAffairs@Foothillgoldline.org)

**Stay ahead of construction, sign up for alerts: [www.foothillgoldline.org](http://www.foothillgoldline.org)**

*\*Construction schedules are subject to change for various reasons, including, but not limited to, weather conditions and unforeseen delays.*